

**PLEASE CHECK WWW.MOLEX.COM FOR LATEST PART INFORMATION**

**Part Number:** [11-18-4111](#)  
**Status:** **Active**  
**Description:** Insulation Anvil

**Documents:**  
[RoHS Certificate of Compliance \(PDF\)](#)

**General**

Product Family	Application Tooling
Series	<a href="#">T1118</a>
Comments	See Tooling Specification (PDF) Above
Function	Cutter
Geographic Area	Global
Level of Automation	Semi-Automatic
More Detailed Tech Information	<a href="mailto:applicationtooling@molex.com">applicationtooling@molex.com</a>
Product Name	N/A
Survey	<a href="http://www.molex.com//review/apptool_survey.html">www.molex.com//review/apptool_survey.html</a>
Tool Type	Anvil
UPC	800753620438

**Physical**

Net Weight	4.420/g
------------	---------

**Material Info**

Old Part Number	60712 11
-----------------	----------

**Reference - Drawing Numbers**

Application Tooling Documents	ATS-STANDARD-PARTS
-------------------------------	--------------------

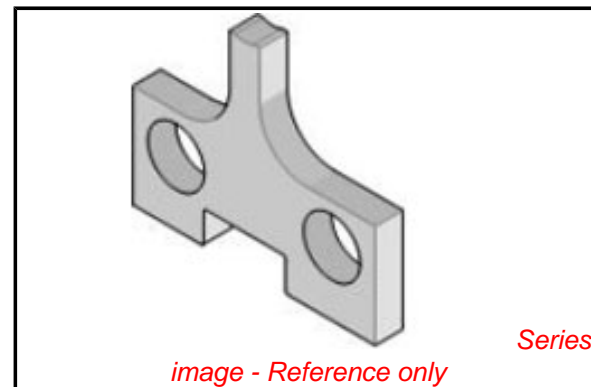

*image - Reference only*

**EU RoHS**

**ELV and RoHS  
Compliant**

**REACH SVHC**

Not Reviewed

**Low-Halogen Status**

Not Reviewed

**China RoHS**



**Need more information on product  
environmental compliance?**

Email [productcompliance@molex.com](mailto:productcompliance@molex.com)  
 For a multiple part number RoHS Certificate of Compliance, [click here](#)

Please visit the [Contact Us](#) section for any non-product compliance questions.

**Search Parts in this Series**

[T1118Series](#)

**Use With**

11-18-2023 , 11-18-2084 , 11-18-3022 ,  
 11-18-3023 , 11-18-3079 , 11-18-3095 ,  
 11-18-3182 , 63888-1100 , 63888-1170 ,  
 63888-1200 , 63888-1270

**PLEASE CHECK WWW.MOLEX.COM FOR LATEST PART INFORMATION**